

MODEL 2565T13 PLUNGER PUMP

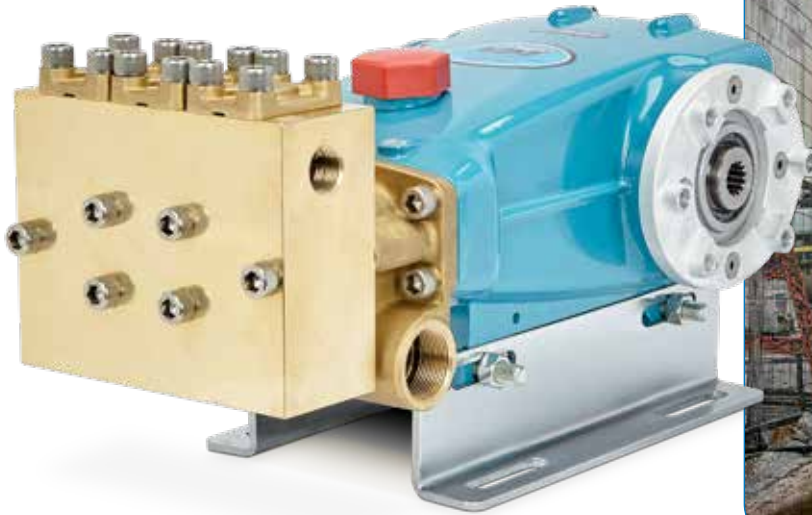

20 GPM | 3,000 PSI

Performance and Durability In a Compact Footprint

Hydro excavating OEMs regularly experience space constraints when designing and building mobile equipment. To address this, the popular Model 2565 has been revamped to fit into an even smaller footprint using a new direct-mount flange and hollow spline shaft that allows it to pair with a compact SAE-B hydraulic motor.

The new 2565T13 design greatly reduces the pump width by more than 7.5 inches compared to a standard bell housing configuration, saving valuable on-board real estate. Matching the standards of other Cat Pumps models, the 2565T13 also features a cast block brass manifold that protects the pump against pressure spikes, cavitation and flaking caused by dirty storage tank water. The crankcase is finished with the industry's most protective pump drive-end paint, a two-coat primer and epoxy finish that shields the cast aluminum crankcase from the harshest job site elements.

Mobile equipment operators face the toughest conditions, so their equipment needs to be equally rugged and durable. That's what Cat Pumps delivers — high-quality, reliable products with unmatched customer service and support.

Features:

- 13-tooth hollow spline shaft allows for direct mounting of 2 or 4-bolt SAE B hydraulic motors.
- 7.5" narrower when compared to a standard 2565 with a bell housing.
- Solid block brass discharge manifold safeguards the pump against high-pressure spikes, cavitation and flaking.
- Wet-end is easily serviceable from the front, allowing quick, on-truck maintenance.
- Same reliable, trusted valve kit used in the 3560 series pumps.
- A durable two-coat electrostatic primer with an epoxy finish protects the crankcase in extreme conditions.

Typical Applications:

- Hydro Excavating
- Sewer Jetting

Specifications

	US MEASURE	METRIC MEASURE
Flow	20 gpm	76 lpm
Pressure	3,000 psi	207 bar
RPM	1450 rpm	1450 rpm
Inlet Pressure Range	Flooded to 70 psi	Flooded to 4.8 bar
Max Liquid Temp	160° F	71° C

	US MEASURE	METRIC MEASURE
Inlet Ports (2)	1 ¼" NPT(F)	1 ¼" NPT(F)
Discharge Ports (2)	¾" NPT(F)	¾" NPT(F)
Weight	92.6 lbs	42 kg
Dimensions	20.35 x 10.66 x 8.58"	517 x 271 x 218 mm

Dimensions

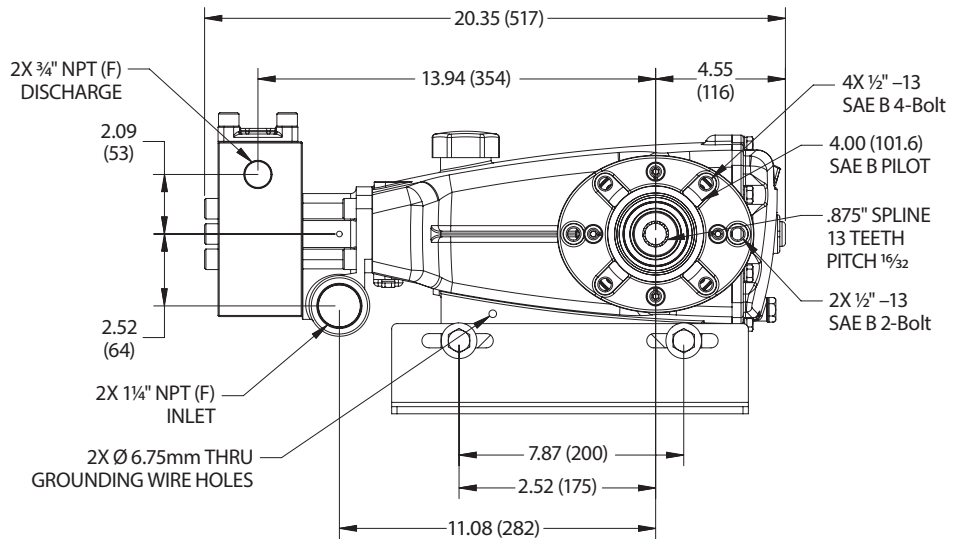
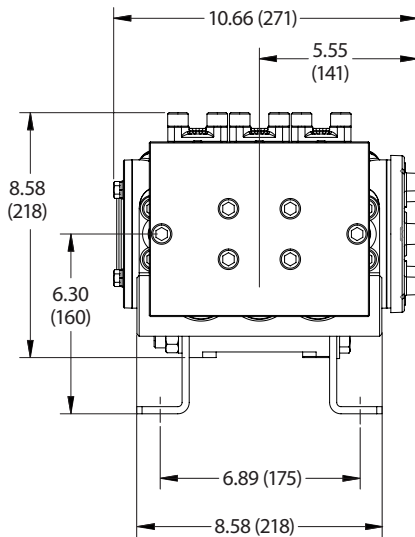

Popular Accessories



Unloader
PN 7542
1 – 21 gpm
406 – 4060 psi



Pop-Off Valve
PN 9940
0 – 25 gpm
1000 – 4000 psi



Pressure Gauge
PN 6089
0 – 6000 psi



Inlet Filter
PN 7107.7
50 gpm Max
1 ¼" NPT(F)



Oil
PN 6102
2.5 Gallon Jug
Specially-Formulated
for Extended Protection

Contact Cat Pumps for more information at info@catpumps.com or (763) 780-5440



CAT PUMPS
1681 – 94TH LANE N.E. MINNEAPOLIS, MN 55449-4324
PHONE (763) 780-5440 — FAX (763) 780-2958
info@catpumps.com | www.catpumps.com